

AVAILABLE

For More Information: www.knoxvilleplant.com



Panasonic
ideas for life

KNOXVILLE, TENNESSEE 277,525 SF on 28.54 Acres

- Air-Conditioned
- Clean Manufacturing
- R&D / Engineering / Executive Office

Size:	277,525 Square Feet	Office:	
	Clean Production and Support: 148,990 sq. ft. Warehouse: 89,021 sq. ft. Office/Employee Support: 39,514 sq. ft.	First Floor:	16,750 sq. ft. featuring: large cafeteria with kitchen, (2) rest rooms, (2) private offices, conference room, telecom room, computer room with raised vented floors, air filtration and a Liebert Challenger 3000 with iCOM for climate control, open office areas. Additional 6,785 sq.ft. of in-plant office featuring: (3) offices, (2) conference rooms, (6) rest rooms, lunch room.
Dimensions:	288' x 647' plus office and offsets	Second Floor:	15,979 sq. ft. featuring: (4) conference / executive offices, (2) rest rooms, telecom room, open office areas. Finishes include: carpeting and vinyl tile floors, painted sheetrock walls, acoustical ceiling tiles with recessed lighting, and 3' x 6' windows.
Lot Size:	28.54 acres	Power:	Supplied by Knoxville Utilities Board
Expansion:	Ample acreage to the north	Primary Power:	13 KV feeding two pad mounted transformers: (1) 1250 kVA, (1) 3750/4200 kVA
Paved Parking:	535 paved and marked	Secondary:	(2) main Square D switchgear, 480/277 volt, 3 phase, 4 wire
Condition:	Excellent	Distribution:	Bus duct and conduit throughout plant above dropped ceiling tile
Dates of Construction:	1982, 7 additions through 2000	Sprinkler:	100% wet: (11) 8" risers in 5 locations. Static pressure: 95 psi Residual pressure: 70 psi
Construction:		Water:	Supplied by Knoxville Utilities Board Main: 10" Fire Protection: 8" Line: 3"
Floors:	5", 6" and 7" reinforced concrete, double epoxy coating in clean production areas.	Sewer:	Supplied by Knoxville Utilities Board Main: 8" Line: 8"
Walls:	Double-T concrete and pre-engineered metal	Natural Gas:	Supplied by Knoxville Utilities Board Main: 8" Four Service Lines: (3) 1" and (1) 2"
Columns:	Steel tubular		
Ceiling:	Metal deck		
Roof:	Mechanically fastened .045" TPO over insulation (replaced 2011) and metal standing seam		
Ceiling Height:	11' 6" - 28' clear		
Warehouse:	26' 6" - 28' clear		
Clean Production:	11' 6" - 14' clear under acoustic tile, 17' 2" - 28' clear under structural beam		
Column Spacing:	Primarily 50' x 50' in warehouse and production areas		



Miscellaneous:

- Security gate house, fully fenced
- Certifications: ISO / IEC 27001 and EMS – 53398
- Freestanding 1,650 sq.ft. Haz Mat building
- Hand wash sinks throughout
- 2,500 sq.ft. mezzanine with mini freight elevator
- DI water lines to specific production areas; DI water system not in place
- Industrial Boiler Co, gas fired boiler: 517 sq.ft. steam lbs/hr, for process steam
- Water supply and floor drains in specific production areas
- (2) 1000 gal. outdoor HPDE tanks

HVAC: Office and Clean Production areas: 52 gas fired rooftop package units for A/C and heat

Warehouse: (37) 24,300 BTU and (4) 160,000 BTU gas fired suspended heaters

Compressed Air:

(1) Gardner Denver Electric Saver EAU99L - 200hp, distributed throughout plant

Air Dryer:

(1) Airtek TW1000, 1000 SCFM, with Silvan Industrial Corp .60G2200 – 2200 gal air receiver tank

Acoustic Anechoic Chamber:

Full Chamber - cut off frequency: 40 Hz; tip to tip dimensions: 15'8"W x 16'8"D x 11'8"H

Lighting: T-12 and T-5 fluorescent and 400W metal halide

Truck Loading:

North Wall: (12) 8' x 10' electric tailgate docks with levelers, shelters, bumpers & bollards
(3) 8' x 10' drive-in doors
(3) 10' x 10' drive-in doors
(2) 10' x 12' drive-in doors

East Wall: (1) 10' x 12' drive-in door

Last Use: Manufacturing electronics: capacitors and speakers

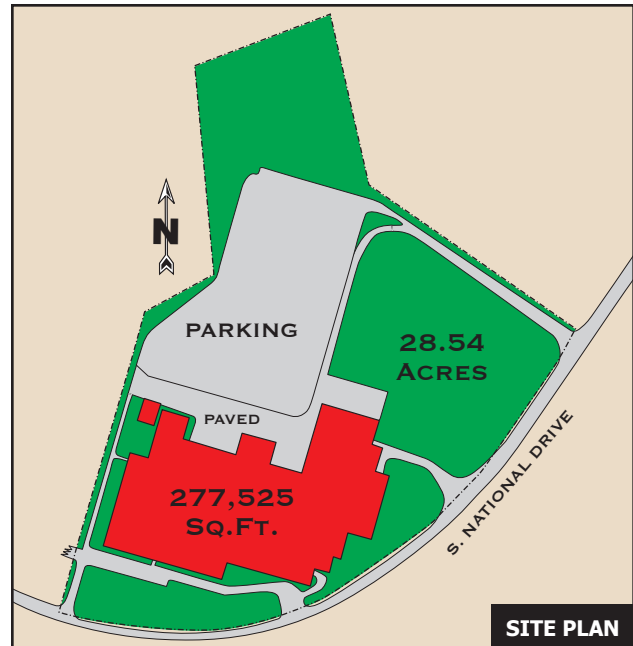

HART CORPORATION
INTERNATIONAL INDUSTRIAL REAL ESTATE

CORPORATE HEADQUARTERS
900 Jaymor Road
Southampton, PA 18966-3820
Phone: (215) 322-5100
Fax: (215) 322-5840/41

SOUTHEAST REGION
3200 Cobb Galleria Parkway, Suite 270
Atlanta, GA 30339
Phone: (770) 874-7980
Fax: (770) 874-7985

Web Site - <http://www.hartcorp.com> E-mail - hart@hartcorp.com

REGIONAL OFFICES

ATLANTA • CHARLOTTE • HARTFORD • KANSAS CITY • PHILADELPHIA

All information furnished regarding property for sale, rental, or financing is from sources deemed reliable, but no warranty or representation is made as to the accuracy thereof and same is submitted subject to errors, omissions, change of price, rental or other conditions, prior sale, lease or financing or withdrawal without notice. No liability of any kind is to be imposed on the broker herein. All rights reserved. You may not mirror, modify or otherwise alter, republish, or print the information contained herein, without written permission from Hart Corporation.

NAI Knoxville
Commercial Real Estate Services, Worldwide.

10101 Sherrill Boulevard
Knoxville, TN 37932
Phone: (865) 777-3030
Fax: (865) 777-3049

**E-mail - tcollins@naiknoxville.com
jroberson@naiknoxville.com
Web Site - <http://www.naiknoxville.com>**